

FLOW & RETURN HEADER KIT

Imax Xtra EL 715 - 1240

These instructions must be read in conjunction with the Installation & Servicing Instructions supplied with the boiler.

KIT CONTENTS

- A. Header - 2 off
- B. DN125 Blank Flange - 2 off
- C. 5" DN125 Gasket - 2 off
- D. M16 x 60 Bolts - 32 off
- E. M16 Nuts - 32 off
- F. DN80 Gasket - 4 off

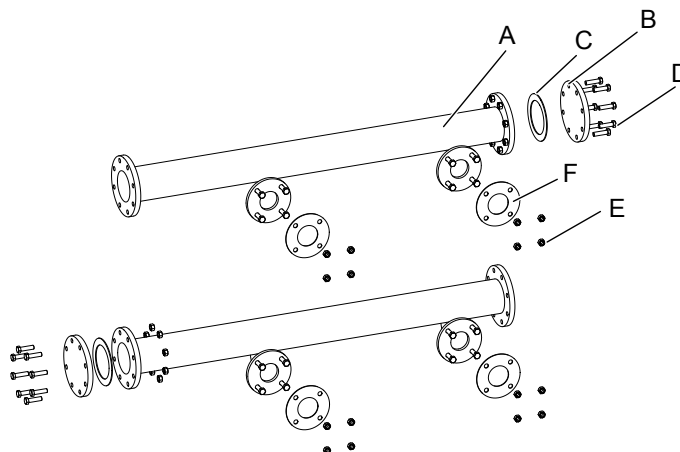

INSTALLING THE FLOW & RETURN HEADER KIT

1. Ensure the singular flow and return manifolds are fitted to the Master and Slave heat exchangers (see Installation Instructions).
2. Connect the blank flanges to opposite ends of the two headers ensuring the DN125 gaskets are fitted. Fitting these blanks at opposite ends should ensure a reverse return circuit is created which is recommended by Ideal Boilers for this appliance.
3. Lift the headers into position in between the Master and Slave Modules and connect to the return manifolds using the nuts and bolts provided again ensuring the DN80 gaskets are fitted.
4. Repeat point 3 for the flow header.

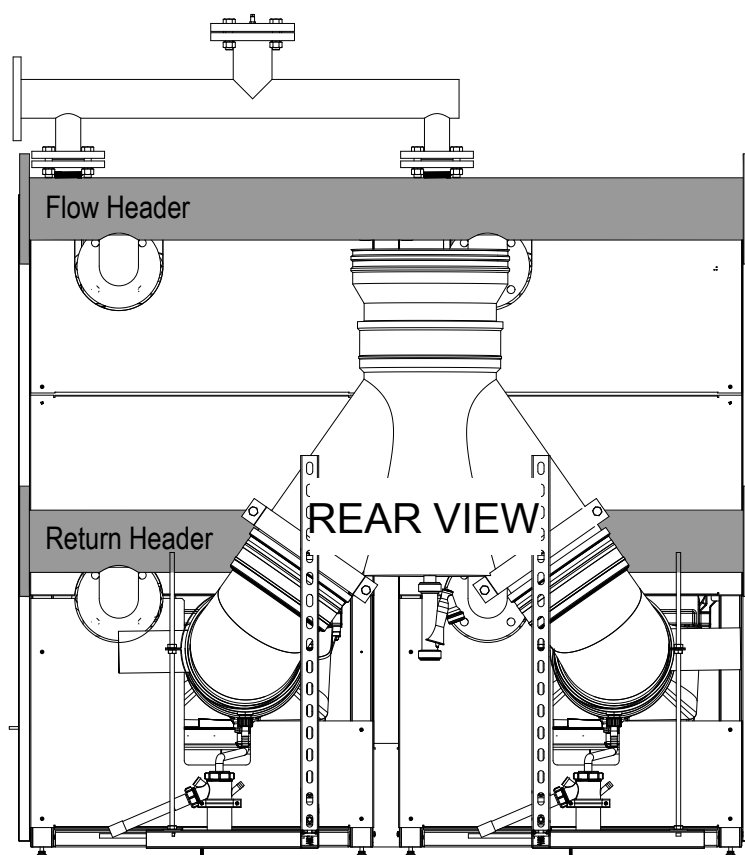

Ideal Boilers Ltd., P.O. Box 103, National Avenue, Kingston upon Hull, HU5 4JN.
Telephone: 01482 492 251 Fax: 01482 448 858. Registration No. London 322 137.

March 2015 UIN 215316 A01



Ideal Boilers Ltd. pursues a policy of continuing improvement in the design and performance of its products. The right is therefore reserved to vary specification without notice.